

Flush-type connector - SACC-DSI-M8MS-4CON-L180 - 1694347

Please be informed that the data shown in this PDF Document is generated from our Online Catalog. Please find the complete data in the user's documentation. Our General Terms of Use for Downloads are valid (<http://download.phoenixcontact.com>)



Sensor/actuator flush-type connector, male, 4-pos., M8, rear/screw mounting with M8 thread, with straight solder connection



Key commercial data

| | |
|------------------------|---------------------|
| Packing unit | 1 |
| Minimum order quantity | 1 |
| Catalog page | Page 38 (PC-2011) |
| GTIN | 4 017918 178680 |
| Custom tariff number | 85366990 |
| Country of origin | GERMANY |

Technical data

General data

| | |
|---------------------------------|------------------|
| Rated current at 40°C | 4 A |
| Rated voltage | 30 V |
| Number of positions | 4 |
| Volume resistance | ≤ 3 mΩ |
| Insulation resistance | ≥ 100 MΩ |
| Ambient temperature (operation) | -25 °C ... 85 °C |

General characteristics

| | |
|--------------------------|--------------------------------------|
| Standards/regulations | M8 plug-in connector IEC 61076-2-104 |
| Coding | A - standard |
| Surge voltage category | II |
| Pollution degree | 3 |
| Degree of protection | IP67 |
| Contact material | CuZn |
| Contact surface material | Au |
| Contact carrier material | PA 66 |
| Material, knurls | Nickel-plated brass |
| Sealing material | NBR |

Flush-type connector - SACC-DSI-M8MS-4CON-L180 - 1694347

Technical data

General characteristics

| | |
|-------------------|---|
| Mounting type | Rear mounting M8 x 0.5 With locking nut |
| Connection method | Solder pins |
| Status display | No |

Classifications

eclass

| | |
|------------|----------|
| eCl@ss 4.0 | 27140815 |
| eCl@ss 4.1 | 27140815 |
| eCl@ss 5.0 | 27143423 |
| eCl@ss 5.1 | 27143423 |
| eCl@ss 6.0 | 27143423 |
| eCl@ss 7.0 | 27449001 |

etim

| | |
|----------|----------|
| ETIM 2.0 | EC001297 |
| ETIM 3.0 | EC002061 |
| ETIM 4.0 | EC002061 |

unspsc

| | |
|---------------|----------|
| UNSPSC 6.01 | 31251501 |
| UNSPSC 7.0901 | 31251501 |
| UNSPSC 11 | 31251501 |
| UNSPSC 12.01 | 31251501 |
| UNSPSC 13.2 | 31251501 |

Approvals

Approvals

Approvals

UL Recognized / cUL Recognized / GOST / GOST / cULus Recognized

Ex Approvals

Approvals submitted

Approval details

Flush-type connector - SACC-DSI-M8MS-4CON-L180 - 1694347

Approvals

| | |
|--------------------------------|-------|
| UL Recognized | |
| Nominal current I _N | 4 A |
| Nominal voltage U _N | 125 V |

| | |
|--------------------------------|-------|
| cUL Recognized | |
| Nominal current I _N | 4 A |
| Nominal voltage U _N | 125 V |

| | |
|------|--|
| GOST | |
|------|--|

| | |
|------|--|
| GOST | |
|------|--|

| | |
|------------------|--|
| cULus Recognized | |
|------------------|--|

Drawings

Schematic diagram

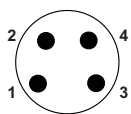

Pin assignment M8 plug, 4-pos., view male side

Drilling diagram

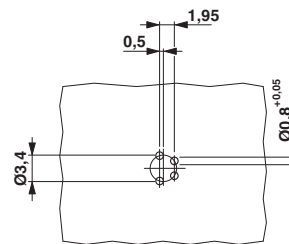

Drilling diagram

Flush-type connector - SACC-DSI-M8MS-4CON-L180 - 1694347

Dimensioned drawing

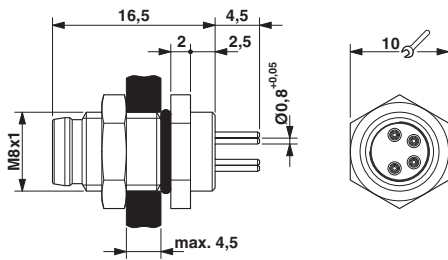

M8 flush-type connector

Flush-type connector - SACC-DSI-M8MS-4CON-L180 - 1694347

Dimensioned drawing

