

REVISIONS						
LOC	DIST	REV	DESCRIPTION	DATE	DWN	APVD
-	-	A	REV PER ECO 15-010930	8-18-15	CT	PD

- MATERIAL:
 BODY: ALUMINUM PER ASTM B317
 INSERT: BRASS PER ASTM B36
- FINISH:
 BODY: .000600 MIN MATTE TIN PER ASTM B545
 OVER .000060 MIN NICKEL PER ASTM B733.
 INSERT: .000150 MIN MATTE NICKEL PER QQ-N-290
- PTFE DRY LUBRICANT 360 DEGREE ON OUTER DIAMETER OF CRIMP BARREL IN ZONE SHOWN.

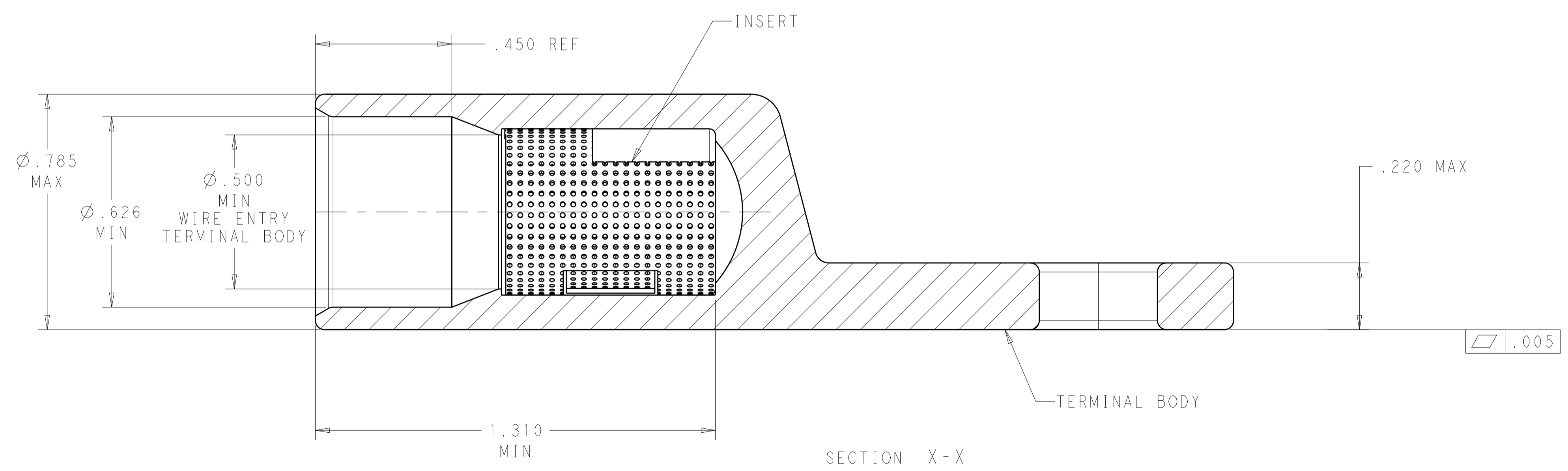
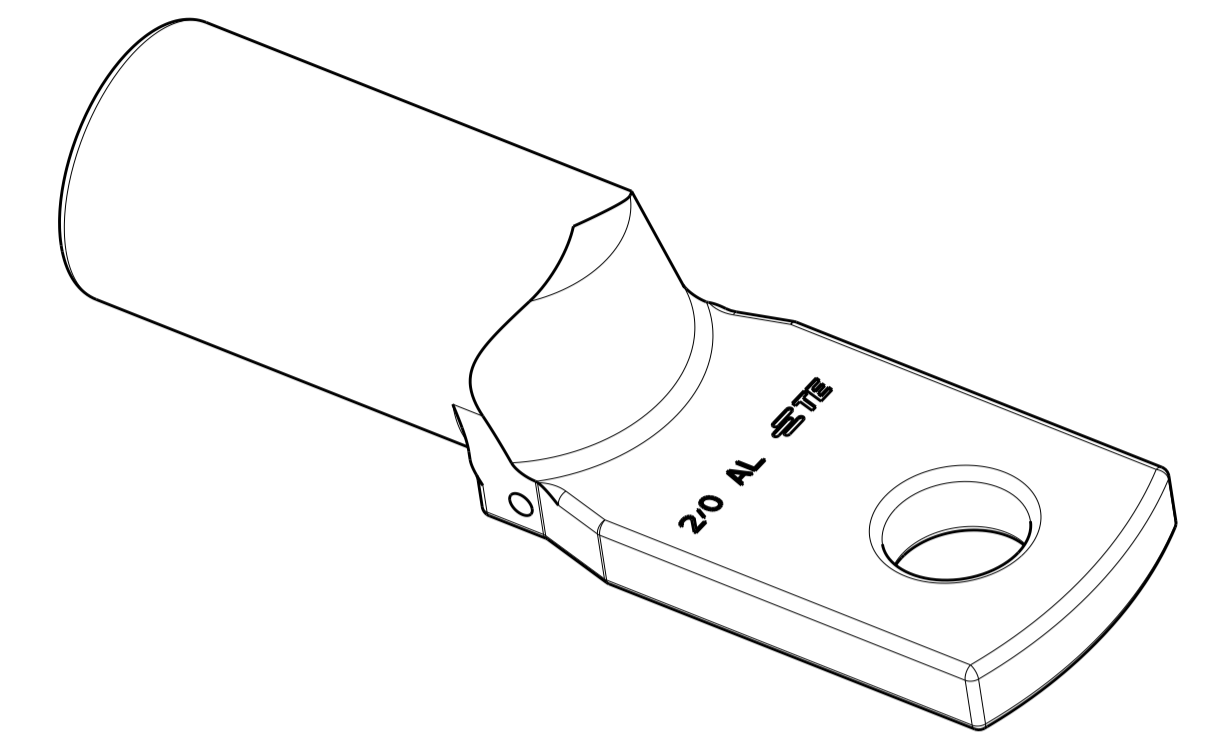
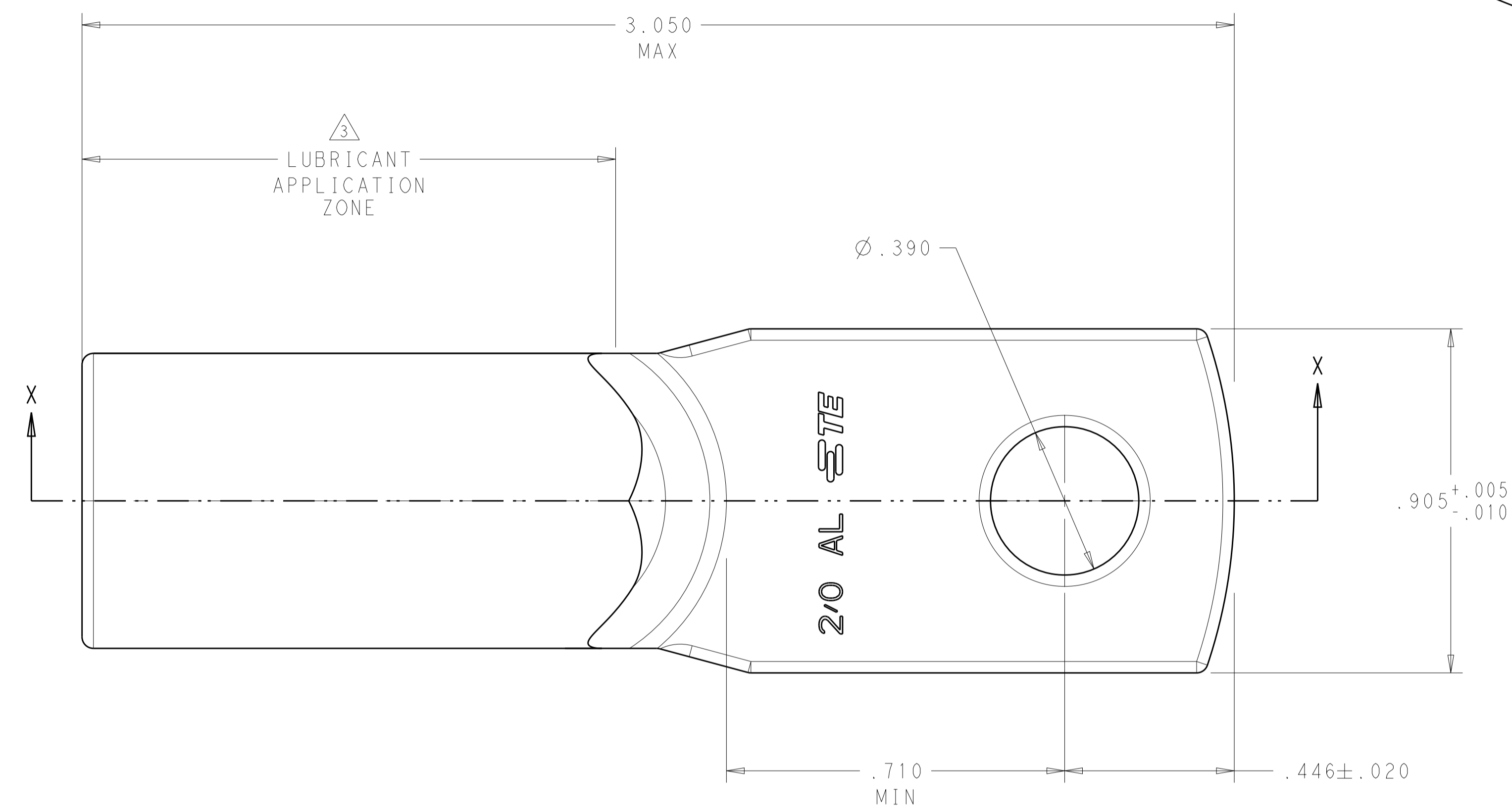

2102573-1
 PART NUMBER

THIS DRAWING IS A CONTROLLED DOCUMENT.		DWN: D. FABIAN 15NOV2011	TE Connectivity	
DIMENSIONS: IN		CHK: DEROCK, KIM 28NOV2012	NAME: ASSEMBLY, ALUMINUM TERMINAL, STRAIGHT, SINGLE HOLE, 270	
TOLERANCES UNLESS OTHERWISE SPECIFIED: 0 PLC ±.1 1 PLC ±.01 2 PLC ±.005 3 PLC ±.0005 4 PLC ±.0005 ANGLES ±1°		APVD: DEROCK, KIM 28NOV2012	RESTRICTED TO: -	
MATERIAL: SEE CALL-OUT		FINISH: SEE CALL-OUT	WEIGHT: -	SCALE: 4:1
Customer Drawing		SIZE: A1	CAGE CODE: 00779	DRAWING NO: 2102573
		SHEET 1 OF 1		REV A